

WELCOME TO THE CINCINNATI ART MUSEUM

Spring 2017

We are pleased you are visiting today. The Art Museum was founded in 1881 and today holds a permanent collection of over sixty thousand pieces of the world's greatest art spanning six thousand years. To make the most of your visit, stop by our Visitor Services Desk to pinpoint the galleries you want to visit, learn about special exhibitions, or receive additional information.

OVERVIEW

ADMISSION FEES

Your general admission to the Cincinnati Art Museum is free every day. This is made possible by a generous gift from The Richard and Lois Rosenthal Foundation. Free admission on Saturday is made possible by The Thomas J. Emery Free Day Endowment established by Mary Emery in 1906. Free general admission for children is made possible in part through an endowment established by the Cincinnati Financial Corporation/The Cincinnati Insurance Companies. There are charges for certain educational programs.

SPECIAL EXHIBITION TICKET FEES

Pricing may vary. Individual Members receive 1 Free Ticket to our Special Exhibitions. Family Members and above receive 2 Free Tickets our Special Exhibitions.

PARKING

Parking is FREE in Museum lots; Museum members have the benefit of preferred parking.

MEMBERSHIP

Make sure you are a part of all the exciting things happening here by becoming a Member of the Cincinnati Art Museum. Members enjoy discounted priority program registration, priority parking, FREE Special Exhibition Tickets, 10% discounts at the Terrace Café, the Museum Shop, and Library book sales, and invitations to exhibition preview parties and more. Stop by the Visitors Services Desk for more information, call 513-639-2966, or visit cincinnatiartmuseum.org.

TOURS

Meet in the lobby for a free public tour weekdays at 1 p.m., Saturdays at 1 and 2 p.m., and Sundays at 1, 2, and 3 p.m. You can also pick up a Family Fun Guide at the Visitor Services Desk. If you wish to attend a tour for a special exhibition, you may need to purchase a ticket.

PHOTOGRAPHIC CONSENT

The Cincinnati Art Museum may photograph or videotape visitors for educational and marketing purposes. Attendance on CAM property is implied consent for the use of visitors' likenesses in print, online, and display materials.

WHAT TO VISIT

TERRACE CAFÉ

Enjoy a full menu of food and beverages, Wi-Fi access, views of the Art Museum's Alice Bimel Courtyard, and seating on the outdoor terrace during warm weather. Art Museum Members receive a 10% discount. The Terrace Café is open Tuesday through Sunday, 11 a.m. to 3 p.m. A limited menu is served on Thursday evenings from 3 p.m. to 7:30 p.m. Café reservations can be made by calling 513-639-2986.

MUSEUM SHOP

Stop by the Museum Shop to find treasures based on our special exhibitions and our permanent collection. The shop is open during regular visiting hours. Art Museum Members receive a 10% discount.

THE MARY R. SCHIFF LIBRARY

Our new library is open Tuesday through Friday from 11 a.m. to 5 p.m. as well as the second Saturday of each month.

THE ROSENTHAL EDUCATION CENTER

Take the family to visit our new education center which is open Tuesday through Sunday 11 a.m. to 5 p.m. On Thursdays the Center is open from 11 a.m. to 8 p.m.

GENERAL POLICIES

BASIC SAFETY POLICIES Please do not touch the art or cases. No food or drink is permitted in the galleries. Children must be accompanied by an adult at all times. For the safety of children and the art, large-framed child carriers are not permitted in the galleries. Small baby slings and small child carriers are permitted, but we ask parents to be mindful of their surroundings while walking in the Art Museum.

COAT ROOM All packages, briefcases, shopping bags, and items larger than 11x15 inches must be stored. The Cincinnati Art Museum is not responsible for items lost or stolen. Lockers are available. Please store umbrellas in the coat room.

WHEELCHAIRS AND STROLLERS The Art Museum provides wheelchairs and strollers free of charge, they are located in the coat rooms by each entrance.

SKETCHING Visitors are welcome to sketch and copy only items in the Art Museum's permanent collection. You can pick up a free permit at the Visitor Services Desk.

SMOKING The Art Museum prohibits smoking, this includes the use of e-cigarettes or other electronic smoking devices.

PHOTOGRAPHY If you see the No Photography icon shown, please refrain from taking photographs or recording video of the related artwork. These works are protected under US copyright law and photography violates the artist's copyright. Special Exhibitions which do not allow photography feature a sign at the entrance which states no photography is permitted. Please no flash photography. We apologize, but tripods, monopods, and or "selfie sticks" are not permitted in the Art Museum.

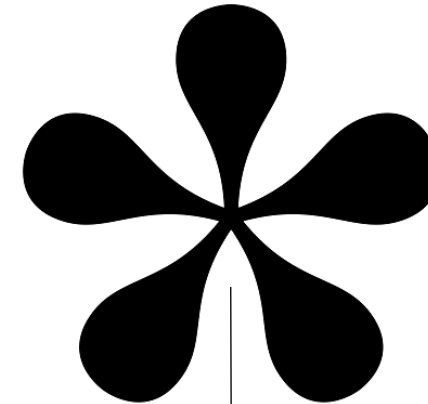

Cincinnati Art Museum

VISITOR GUIDE

Open Tuesday through Sunday 11:00 a.m.–5:00p.m.

Late hours every Thursday 5:00 p.m.-8:00 p.m.

Closed on Mondays and select holidays.

FLOOR PLAN

* *William Kentridge: More Sweetly Play the Dance*

Tiffany Glass: Painting with Color and Light *

1ST FLOOR

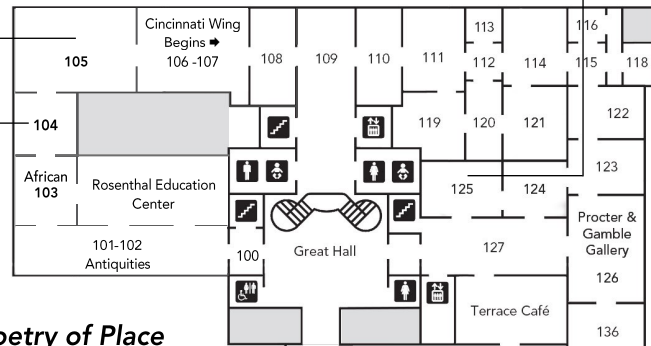

* *The Poetry of Place*

GROUND FLOOR

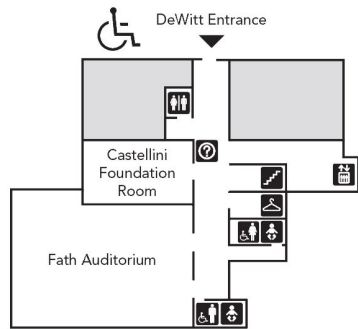

Dressed to Kill: Japanese Arms and Armor *

2ND FLOOR

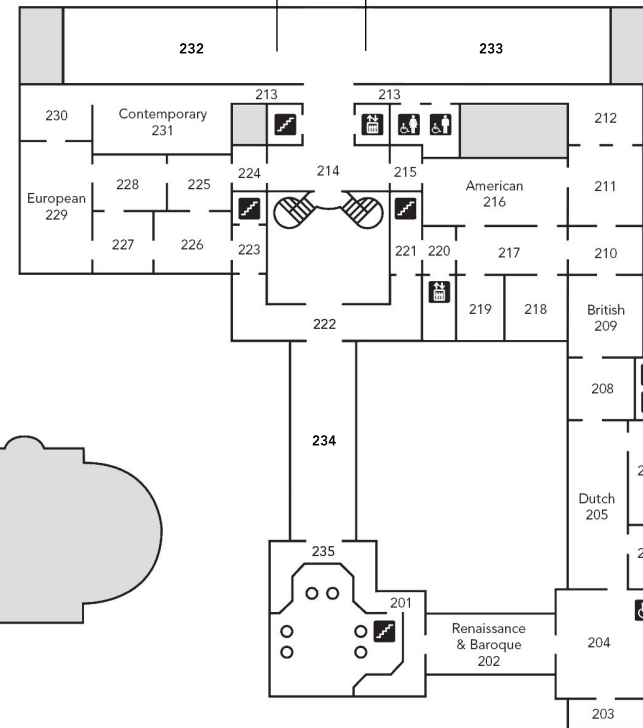

* *Transcending Reality: The Woodcuts of Kosaka Gajin* *

3RD FLOOR

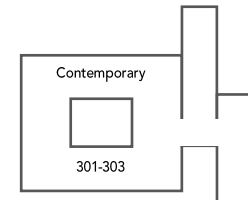

SPECIAL EXHIBITIONS

William Kentridge: More Sweetly Play the Dance
(April 26, 2017 - November 5, 2017)
Gallery 105

Tiffany Glass: Painting with Color and Light
(April 1, 2017 - August 13, 2017)
Gallery 123-125

*Dressed to Kill: Japanese Arms and Armor**
(February 11, 2017 - May 7, 2017)
Gallery 232
* Ticket Required

*Transcending Reality: The Woodcuts of Kosaka Gajin**
(February 11, 2017 - May 7, 2017)
Gallery 233
* Ticket Required

The Poetry of Place: William Clift, Linda Connor, and Michael Kenna
(December 10, 2016 - June 11, 2017)
Gallery 104

LEGEND

- INFORMATION DESK
- MENS & WOMENS RESTROOM
- UNISEX | FAMILY RESTROOMS
- WHEELCHAIR ACCESS
- BABY CHANGING STATIONS
- STAIRS
- ELEVATORS
- COAT ROOM

All wheelchair accessible restrooms have baby changing stations.

Ask at the Front Desk about the easiest **wheelchair access** to reach the new Mary R. Schiff Library and Archives on the third floor of the new Longworth Wing.

Please **no photography** in the special exhibitions.
Read over our photography policy on the back of the map