

floorplan

1st Floor

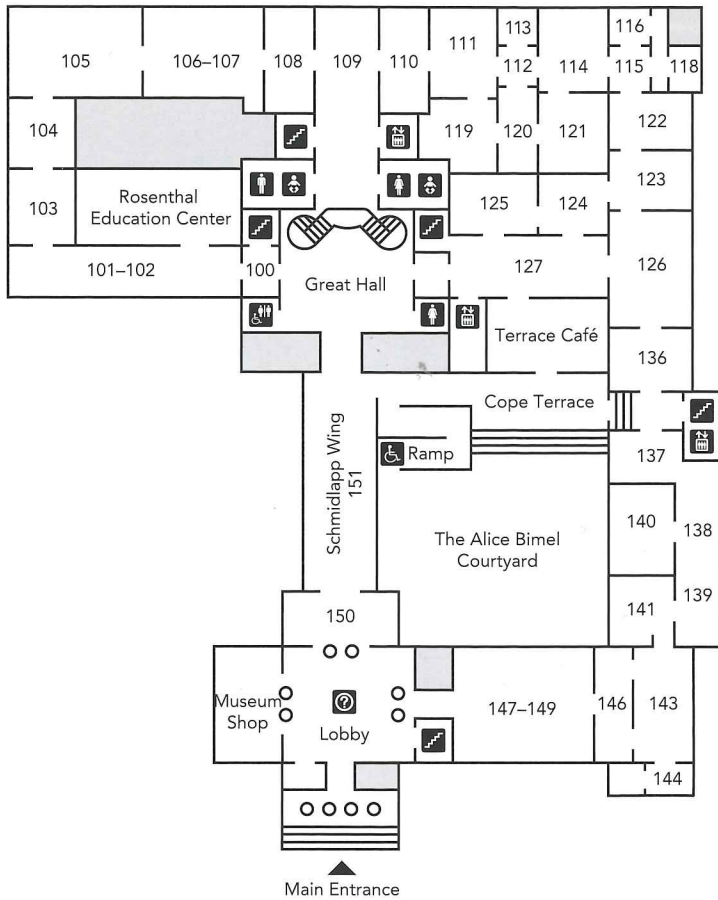

2nd Floor

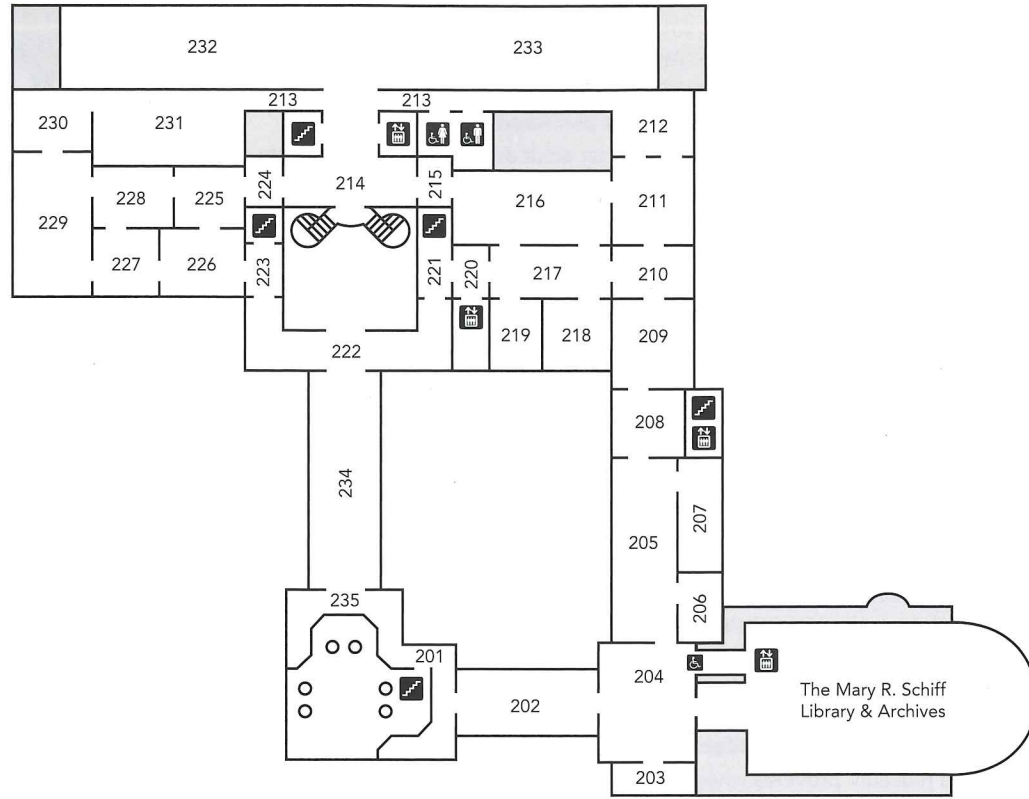

Ground Floor

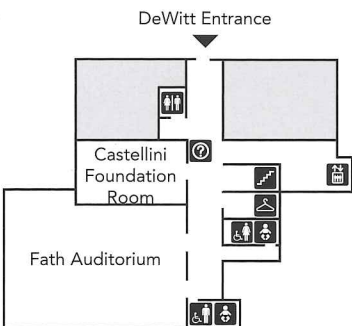

3rd Floor

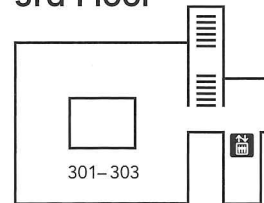

Legend

- Information Desk
- Restrooms
- Stairs
- Wheelchair Access
- Elevators
- Baby Changing Stations

what to visit

Terrace Café

Enjoy a delicious selection of art-inspired fare, friendly servers and a tranquil atmosphere in our Terrace Café. Outdoor seating may be available in the scenic Alice Bimel Courtyard in warm weather. Museum members receive a discount. The Terrace Café is open Tuesday–Sunday, 11 a.m.–3 p.m. A limited menu is served on Thursday evenings from 3–7:30 p.m. Café reservations can be made by calling 513-639-2986.

Museum Shop

Find unique gifts and keepsake souvenirs based on our special exhibitions and the museum's permanent collection. The shop is open during regular museum hours. Complimentary gift wrap available. Members receive a discount.

The Mary R. Schiff Library

With a collection of over 100,000 items spanning 6,000 years of art history, the library is open to the public with highly-qualified librarians to assist visitors. Located on the third floor in the Longworth Wing, the library is Tuesday–Friday from 11 a.m.–5 p.m. as well as the second Saturday of each month.

The Rosenthal Education Center

The Rosenthal Education Center (REC) is an interactive space for families to explore art together. Located on the first floor just off the Great Hall, the REC is open Tuesday–Sunday 11 a.m.–5 p.m. Thursday hours are 11 a.m.–8 p.m.

Coffee Bar

Have a seat and enjoy cookies and a cup of gourmet coffee or tea. Open during regular museum hours, but closes 30 minutes before museum closing time.

special exhibitions

Albrecht Dürer: The Age of Reformation and Renaissance
November 17, 2017–February 11, 2018 | Gallery 234–235

***Iris van Herpen: Transforming Fashion**
October 13, 2017–January 7, 2018 | Gallery 232–233

Ana England: Kinship
September 8, 2017–March 4, 2018 | Gallery 124–125

Fashion and Technology
July 1, 2017–December 31, 2017 | Gallery 104

William Kentridge: More Sweetly Play the Dance
April 26, 2017–May 20, 2018 | Gallery 105

*Denotes ticketed exhibition. Pricing varies.