



visitor guide

cincinnati  art museum

cincinnatiartmuseum.org

welcome to the cincinnati art museum

Founded in 1881, our museum holds a diverse, encyclopedic permanent collection of more than 67,000 works spanning 6,000 years.

In addition to displaying our own collection, the museum also hosts several national and international traveling exhibitions each year. The museum has a wide range of virtual and in-person art-related programs, activities, and special events.

More information and digital ways to connect are available at cincinnatiartmuseum.org

As a step toward honoring the truth and achieving healing and reconciliation with those Indigenous peoples who were affected most by the Doctrine of Discovery and broken treaties, we acknowledge the traditional Shawnee and Myaamia lands on which we now stand, and on which the city of Cincinnati was built. *Language provided by the Greater Cincinnati Native American Coalition.*

Generously supported by:



Art Climb

Located at the corner of Gilbert Avenue and Eden Park Drive, the museum's Art Climb is a pedestrian pathway and a civic engagement space for outdoor art, programming, and community gathering. There are currently several outdoor sculptures on view. Art Climb is open seven days a week.

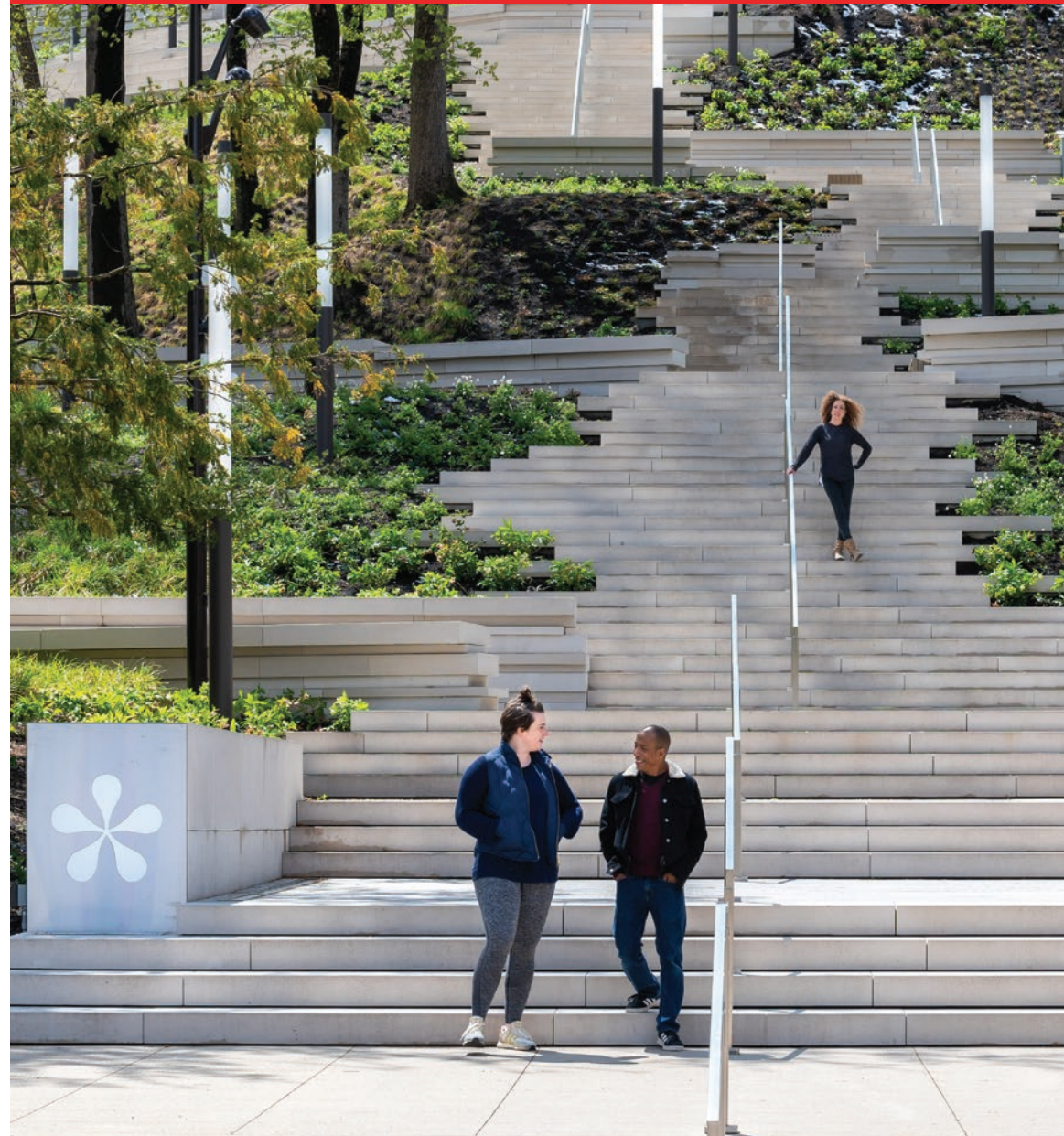

overview

Admission Fees

General admission is free every day, made possible by a gift from the Rosenthal Family Foundation.

Special Exhibition Ticket Fees

Pricing varies. Purchase tickets at the front desk or at cincinnatiartmuseum.org

Membership

Members enjoy FREE special exhibition tickets, discounts at the Terrace Café and Museum Shop, discounted program registration, invitations to exhibition preview events and more. Stop by the Visitor Services Desk for more information, call (513) 639-2966, or visit cincinnatiartmuseum.org/membership

Tours

Guided and self-guided adult or school tours as well as virtual school tours can be scheduled by calling our Tour Coordinator at (513) 639-2975 or by emailing tours@cincyart.org.

Device Charging

Outlets are located near the sitting area in the Schmidlapp Wing (Gallery 151) to charge personal electronics.

Photography

Personal photography without flash is allowed in the permanent collection galleries unless otherwise posted. Professional photography requires advance arrangements (of at least two weeks), please email special.events@cincyart.org to schedule.

The museum may photograph or record video of visitors for educational and marketing purposes. Attendance on museum property is implied consent for the use of visitors' likenesses in print, online, and on display materials. If you prefer not to be photographed, please notify our photographer.

general policies

- Please do not touch the artwork. Please keep a safe distance from all paintings, sculptures, and cases (approximately arm's length or three feet away).
- Food, drinks, and gum are not permitted within the galleries.
- Smoking is prohibited, including the use of e-cigarettes or other electronic smoking devices.
- Works of art are occasionally rotated off view and galleries are closed periodically for a variety of reasons. Please inquire at the Visitor Services Desk for information on specific works of art or gallery closures.
- All large bags will be inspected upon arrival. Coat room and lockers are available in the Main Lobby and DeWitt entrance. All backpacks, packages, briefcases, shopping bags, umbrellas, and other large items (larger than 11 x 15 x 4 in.), must be left in the coat room in the lockers provided. The museum is not responsible for lost or stolen items.
- Children must be accompanied by an adult at all times. For the safety of children and the art, large-framed child carriers are not permitted in the galleries. Small baby slings and less bulky child carriers are allowed, and we ask parents to be mindful of their surroundings.
- A limited number of strollers and wheelchairs are available free of charge in the coat room off the Main Lobby and DeWitt entrance.
- Pencils are permitted in the galleries; pens and markers are prohibited.
- Visitors who wish to copy a work of art using materials other than pencil must complete a copyist permit at the Visitor Service Desk.
- If you get lost or have any questions, there are gallery attendants stationed throughout the museum to help.
- Please visit cincinnatiartmuseum.org for additional policies.

accessibility

We strive for inclusivity by increasing accessibility to our collection, programming, and resources. We seek to eliminate barriers by accommodating the individual needs of all visitors.

For accessibility tools or if this map does not suit your needs, please stop by our Visitor Services Desk. We can provide sensory headphones, fidgets, and a large print Accessibility Guide that includes quiet spaces, seating areas, low light spaces, and hands-on areas.

 We hope to continuously improve our efforts. Visit cincinnatiartmuseum.org/access to learn more or for additional resources including social narratives and audio description videos. To help make our collection accessible to everyone, regularly scheduled programs are designed for people of varying abilities. If you have questions or need additional accommodations, please contact us at access@cincyart.org.

Follow us

 @CincinnatiArtMuseum

 @CincyArtMuseum

 CAM Connect

 @CincyArtMuseum

We want to hear about your experience at the museum. Email us at CAMlistens@cincyart.org.



what to visit

- Terrace Café**
Open Tuesday–Sunday, 11 a.m.–3 p.m. and Thursday, 11 a.m.–7:30 p.m.
- Museum Shop**
Open during regular museum hours. Complimentary gift wrap available.
- MyCAM**
MyCAM Art Hunts are digital tours that you customize.
- The Mary R. Schiff Library**
Open to the public Tuesday–Friday from 11 a.m.–5 p.m. as well as the second Saturday, September through June.
- Rosenthal Education Center**
Open during regular museum hours.
- Information**
lorem ipsum dolor etus

- Special Exhibition & Feature Spaces**
- Ancient Art**
Ancient Middle Eastern art is in Galleries 147–9; art from the Ancient Mediterranean World is in Galleries 101–2.
- African Art**
- American Art**
Cincinnati Wing is in Galleries 106–26.
- Asian & Islamic Art**
South Asian art is in Gallery 143; art from the Islamic World is in Galleries 144–46; East Asian art is in Galleries 136–41.
- European Art**
14th- to 18th-century European art is in Galleries 201–10; 19th- and 20th-century European art is in Galleries 225–29.
- Modern & Contemporary Art**

- Elevator A**
Access to floors G–2
- Elevator B**
Access to floors 1–3
- Elevator C**
Access to floors 1–2
- Elevator D**
Access to Library
- Explore Cincinnati Art Museum's grounds, including the Art Climb.
- Recycling bins are located in the Main Lobby, Great Hall, Courtyard, and DeWitt Entrance. Please visit cincinnatiartmuseum.org/green for information on our commitment to environmental sustainability.

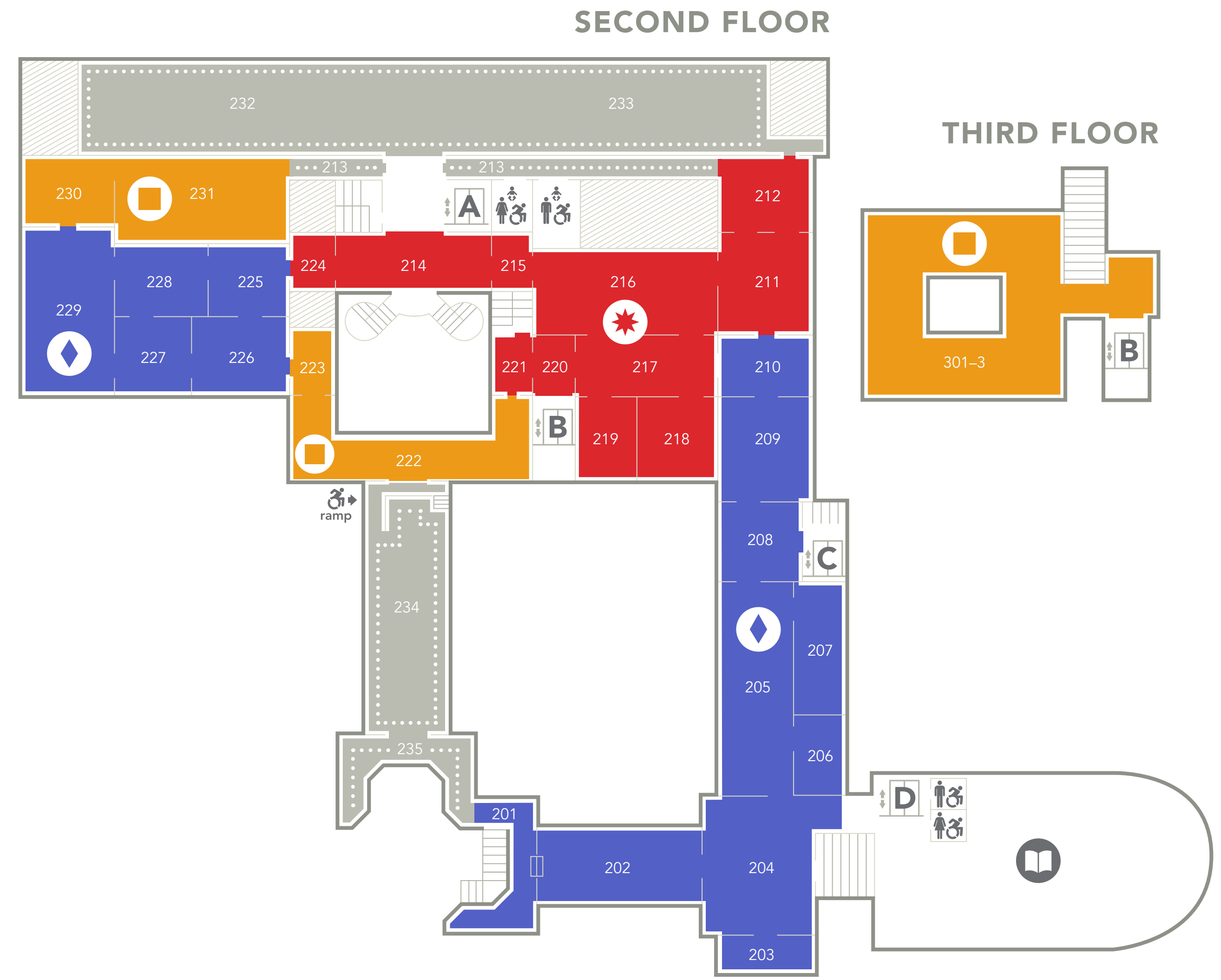
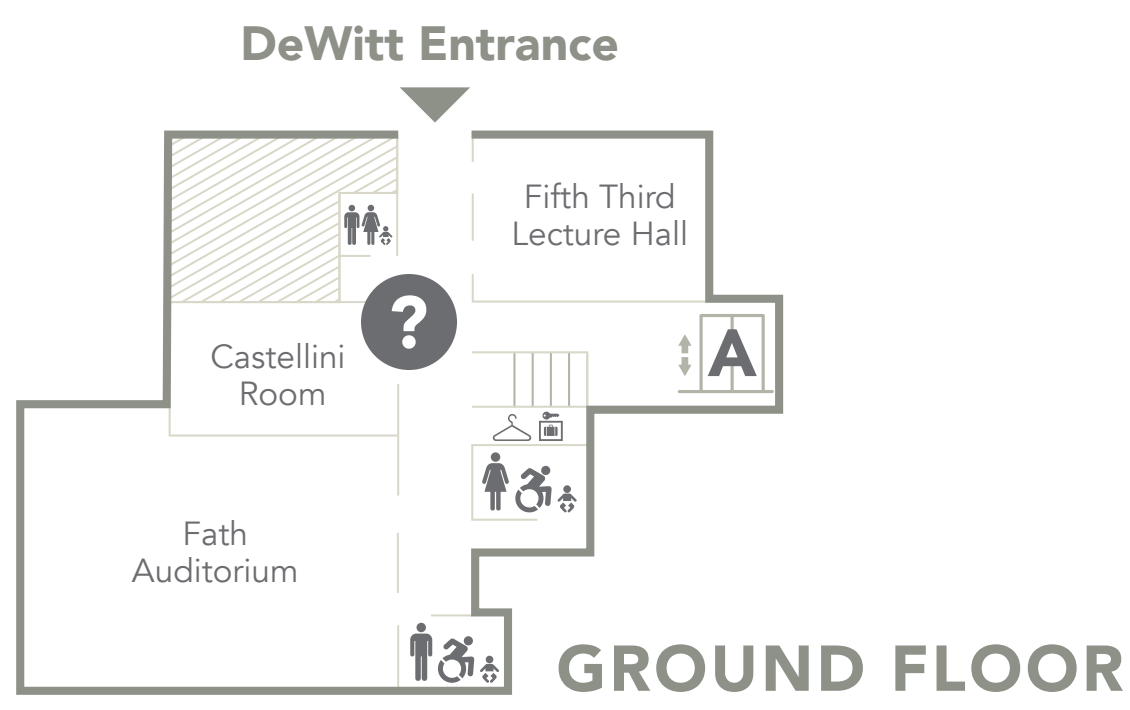

our mission

Through the power of art
we contribute to a more vibrant Cincinnati
by inspiring its people
and connecting our communities.

Diversity is integral to the power of art;
Equity is central to a vibrant future Cincinnati region;
Inclusion is a path to inspiring people;
Accessibility is a core of connected communities.

cincinnati  art museum

cincinnatiartmuseum.org